

WICTEC 60

Stick system curtain wall

Featuring a 60-mm face width (inside and outside), WICTEC 60 is a stick system façade that meets the highest demands. With minor additions, WICTEC 60 fulfils the most demanding requirements with regard to burglar and bullet resistance and fire protection.

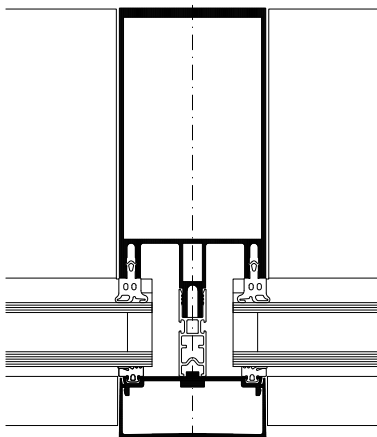

Technical performance:

System width:	60 mm
Profile depth:	70 mm to 170 mm
Thermal insulation:	U_i value up to 1.2 W/(m ² K)
Infill thickness:	3 mm to 51 mm
Glass weight:	up to 5.6 kN
Roof pitch:	up to 10°

System technology:

- Ideal for vertical façades and sloped-glazing and spatial-structure transitions
- Individual design thanks to a wide range of profile geometries for the structural and glazing profiles
- Reliable glass load transfer (up to 5.6 kN), with adapted transom-joint technology
- Overlapping and secure drainage at the cross point, without mechanical mullion processing, ensures tried-and-tested impermeability
- Filigree look without any change in appearance to the inner mullion and transom gaskets
- High static value of profiles, with the additional option of interior reinforcement
- Glazing from outside with concealed or visible screws
- Extensive solutions for structure junctions and conservatories

System test results / CE product pass in accordance with DIN EN 13830

Air permeability:	Class AE
Watertightness:	RE 1200
Resistance to wind load:	2000 / -3200 Pa, security 3000 / -4800 Pa
Sound insulation:	$R_w (C; C_{tr}) = 47 (-1; -4)$ dB
Impact resistance:	Class E5 / I5
Burglar resistance:	RC1N, RC2N, RC2, RC3
Bullet resistance:	FB4
Quality assurance:	Certified according to ISO 9001:2008